

DS-K4H258SS Single-Door Magnetic Lock

The DS-K4H258SS Single-Door magnetic lock is designed for wooden door, glass door, and steel door with the opening angle of 90°. The maximum holding force of the lock is 280 kg (617.4 lbs). It can be used for controlling door opening/closing, and the indicator shows the door status.



Available Model

DS-K4H258SS

Key Features

- The magnetic lock supports the maximum holding force of 280 kg (617.4 lb)
- Default voltage is 12 VDC
- It is equipped with internal voltage dependent resistor (MOV)
- It is applied to wooden door, glass door, metal door and fireproof door
- LED indicator displays the status of door lock
- Anti-residual magnetism design
- Abrasion-proof materials
- The shell is made up of aldural and is hard anodizing electroplated
- No mechanical failure, and the magnetic lock works by electromagnetism force



Specifications

Model	DS-K4H258SS
Dimension of lock body (L × W × H)	238 mm × 47 mm × 27 mm (9.4" × 1.9" × 1.1")
Dimension of armature plate (L × W × H)	182 mm × 38 mm × 12.5 mm (7.2" × 1.5" × 0.5")
Unlock method	Current interruption
Maximum holding force	280 kg (617.4 Lbs) linear thrust
Input voltage	12 VDC
Working current	340 mA
LED indicator	Green (work status)
Suitable door	Wooden door, glass door, metal door, fireproof door
Surface temperature	≤ ambient temperature 20 °C (68 °F)
Working temperature	-10 °C to 55 °C (14 °F to 131 °F)
Working humidity	0 to 95% (relative humidity)
Shell	Hard anodizing electroplating operated
Lock body	Eco-friendly Nickel electroplating operated
Armature plate	Eco-friendly Nickel electroplating operated
Weight	2.02 kg (4.5 lb)

Dimension

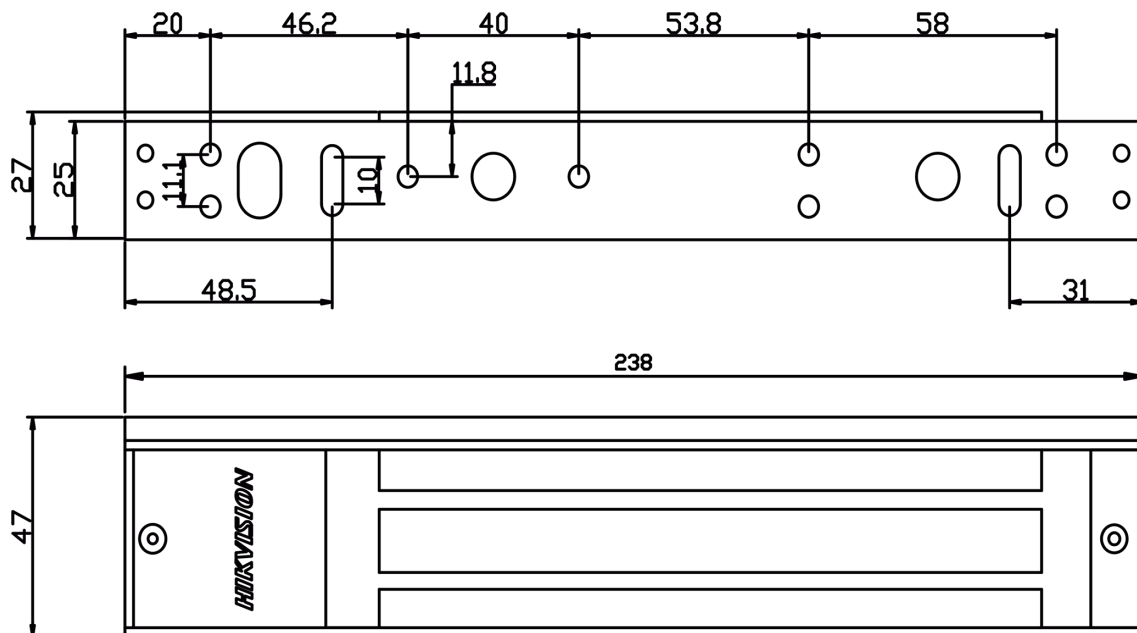

Circuit Board Diagram

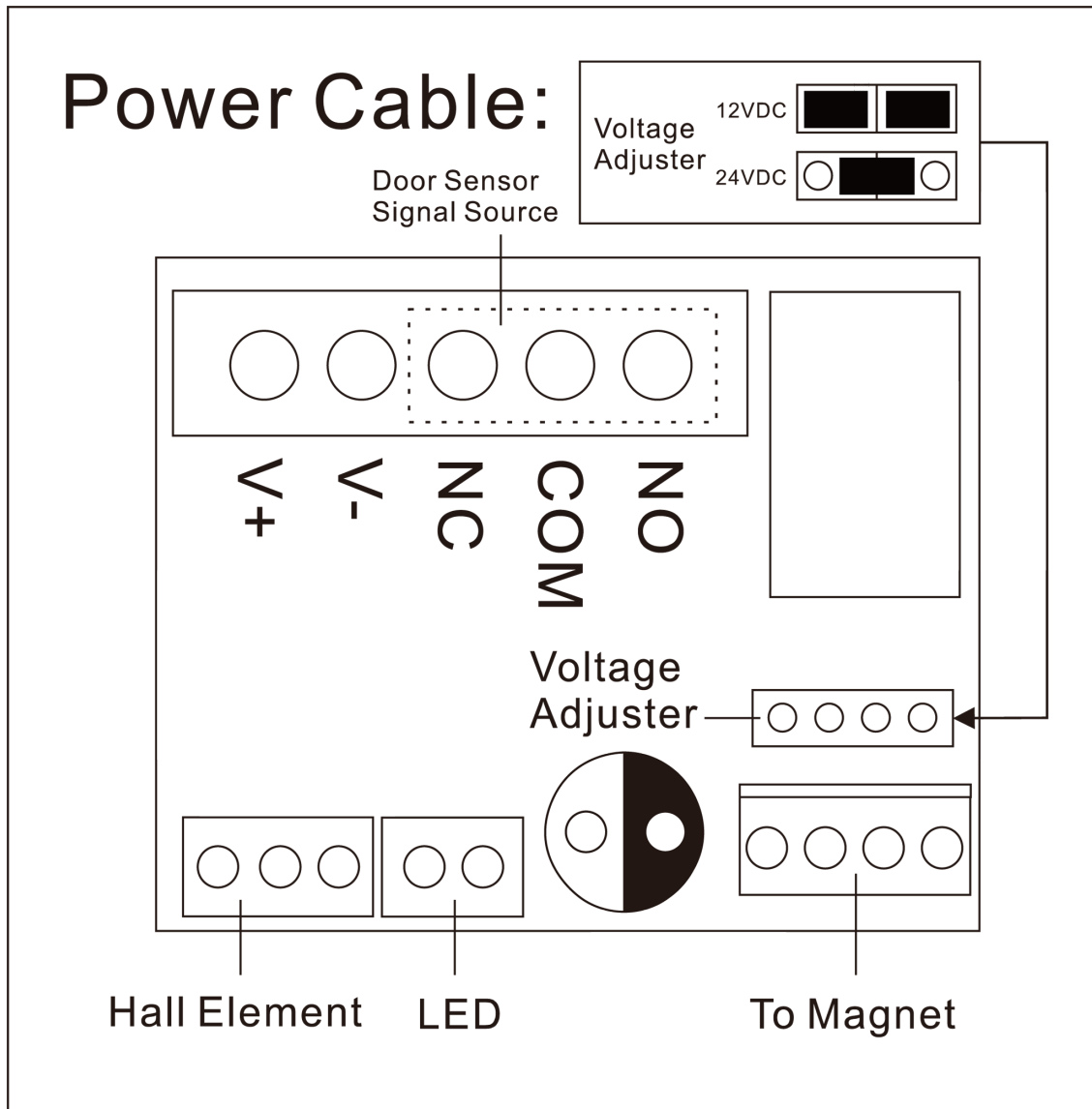

Installation

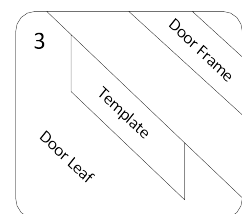
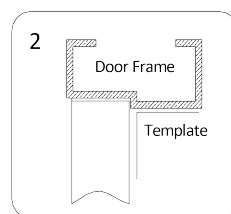
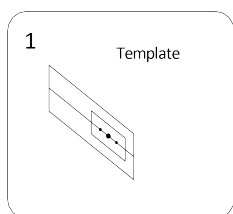
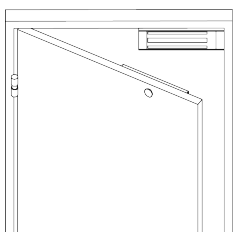

Fold the plate to 90°.

Close the door first, then place the upper side of template on door frame, while adjust the left side next to the door leaf.

Mark screw positions of armature plate and magnetic lock on door leaf and door frame respectively.

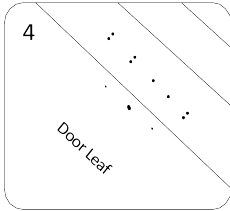

Drill holes based on the marked positions.

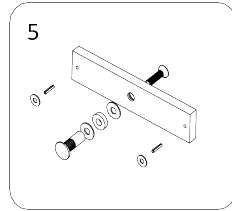

Make a combination based on the picture.

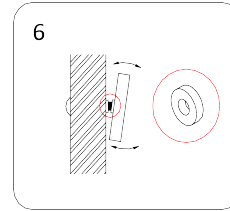

Place the rubber ring between armature plate and door leaf.

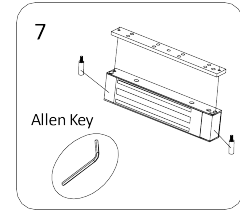

Use Allen key to remove the mounting plate from lock body.

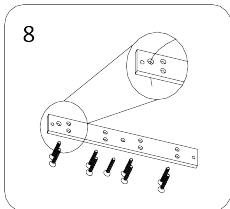

Fix the mounting plate on the door frame according to the holes drilled earlier.

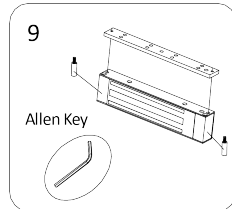

Use Allen key to screw the lock body on the mounting plate.

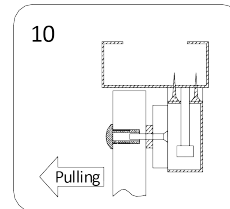

Close the door to test holding force. The angle between armature plate and magnetic lock can be adjusted by adding or reducing washers.

Distributed by



HIKVISION®

Headquarters

No.555 Qianmo Road, Binjiang District,
Hangzhou 310051, China
T +86-571-8807-5998
overseasbusiness@hikvision.com

Hikvision USA
T +1-909-895-0400
sales.usa@hikvision.com

Hikvision Australia
T +61-2-8599-4233
salesau@hikvision.com

Hikvision India
T +91-22-28469900
sales@pramahikvision.com

Hikvision Canada
T +1-866-200-6690
sales.canada@hikvision.com

Hikvision Thailand
T +662-275-9949
sales.thailand@hikvision.com

Hikvision Europe
T +31-23-5542770
sales.eu@hikvision.com

Hikvision Italy
T +39-0438-6902
info.it@hikvision.com

Hikvision Brazil
T +55 11 3318-0050
Latam.support@hikvision.com

Hikvision Turkey
T +90 (216)521 7070- 7074
sales.tr@hikvision.com

Hikvision Malaysia
T +601-7652-2413
sales.my@hikvision.com

Hikvision UK & Ireland
T +01628-902140
sales.uk@hikvision.com

Hikvision South Africa
Tel: +27 (10) 0351172
sale.africa@hikvision.com

Hikvision France
T +33(0)1-85-330-450
info.fr@hikvision.com

Hikvision Kazakhstan
T +7-727-9730667
nikia.panfilov@hikvision.ru

Hikvision Vietnam
T +84-974270888
sales.vt@hikvision.com

Hikvision UAE
T +971-4-4432090
salesme@hikvision.com

Hikvision Singapore
T +65-6684-4718
sg@hikvision.com

Hikvision Spain
T +34-91-737-16-55
info.es@hikvision.com

Hikvision Tashkent
T +99-87-1238-9438
uzb@hikvision.ru

Hikvision Hong Kong
T +852-2151-1761
info.hk@hikvision.com

Hikvision Russia
T +7-495-669-67-99
saleru@hikvision.com

Hikvision Korea
T +82-(0)31-731-8817
sales.korea@hikvision.com

Hikvision Poland
T +48-22-460-01-50
info.pl@hikvision.com

Hikvision Indonesia
T +62-21-2933759
Sales.Indonesia@hikvision.com

Hikvision Colombia
sales.colombia@hikvision.com